

INTERNATIONAL

RECYCLING & WASTE CONTAINERS



The **#1 Rated** Brand in
Recycling & Waste Containers!

★ Trustpilot



Innovative Designs Inspiring Change.



**GREAT
PEOPLE**
WORKING
TOGETHER
to create
**POSITIVE
CHANGE**
IN THE WORLD 

WHY BUSCH?



Certified B Corporation®

We are proud to be a part of a global movement of people using business as a force for good™



With 40+ years' **Experience**

we know our stuff and love to share it!



We strive to maximize
Recycled Content
in our containers!



Tailored By You

Customization is our
middle name!



Plasticbank

Busch Systems is directly contributing
to five of the 17 United Nations
Sustainable Development Goals.



The Most Trusted

#1 rated recycling & waste container
brand according to Trustpilot.



Made in
North America
Promise



We're proud to be a
Living Wage Employer



Giving Back

We support local and
national charities.



We track our
Carbon Footprint
on every product via CarbonGraph.

In an effort to produce a more sustainable catalog with fewer pages, we have intentionally not included all of our products here. Contact our sales team at 1-800-565-9931 or check out our website to see our full product line!



Printed on 100% Recycled Paper. FSC® Certified.



MISSION STATEMENT

To support everyone who cares about waste diversion with leading edge products and services that maximize the quantity and quality of their recycling program.



A MESSAGE FROM CRAIG BUSCH

2025 marks not only a significant point in history for Busch Systems, with 40 years in business, but an important point in history. Having been in this industry over the last 40 years, starting with the earliest days of the recycling movement, I have had the opportunity to see and learn a lot. Anybody can say anything about themselves – what is true? What is real? Who is really making an effort to be impactful? Busch Systems is more committed than ever to supporting sustainable and eco-conscious business choices and being completely transparent - measured and measurable. It's more important than ever to separate ourselves as global leaders in this industry.

We continue to stand by our business values and our products – recertifying our Certified B-Corporation® status with a higher overall B Impact Score than 2019; transparently tracking and measuring the carbon footprint of our product line with CarbonGraph; and ethically supporting the global ocean cleanup

efforts of Plastic Bank, helping to stop over 3.1 million bottles from entering our oceans. As thought leaders, we are invested in sharing our knowledge with others through our Green Thinking Webinar Series, led by our Senior Advisor, Alec Cooley, along with our new Podcast Series: Talkin' Trash with Will Nash.

Over the last 40 years we have made a conscious decision to not only make the best diversion containers, but to be leaders and innovators. While I can't yet share with you all the amazing things to come, I can tell you that it is going to be our most innovative year yet!

On behalf of all of us at Busch Systems®, we wish to thank you for being a part of our family for 40 incredible years!

Craig Busch

Founder, President & Chief Design Officer



We're committed to doing business for the greater good –that's why we're proud to be a B Corp™.

A Certified B Corporation® since 2019, we're one of over 9,000 companies across 105 countries and 160 industries redefining success in business. "We're honored to be a part of the B Corp community," says Craig Busch, President & CEO. "It lets us be bold about who we are and what we believe in—and to make greater impact in the world as a recycling & waste management industry leader." B Corporations voluntarily meet high criteria for social and environmental performance, accountability and transparency. We have committed to using business as a force for good, assessing the work that we do and the way that we do it, and continually implementing processes and practices that consider the impact our business has on all stakeholders – employees, customers, society and the environment.

To learn more about B Corp™, visit: buschsystems.com/b-corp



Working together to make a difference! We are proud to have partnered with CarbonGraph.

Innovation is at the heart of what we do, and we are proud to have partnered with CarbonGraph, an innovative technology, to determine the carbon footprints of our products. Founded in 2021, CarbonGraph's mission is to provide people, companies and governments the environmental context needed to make informed decisions about the sustainability of the goods and services they buy and sell.

In addition to mapping the carbon footprint of our products, the Busch Systems team has been working hand-in-hand with the CarbonGraph team to develop their software and be an example of the steps other companies can take in measuring their environmental impact through data and technology.

To learn more about CarbonGraph, visit: buschsystems.com/carbon-footprint



Plastic Bank empowers the Social Recycling movement that stops ocean plastic and helps alleviate poverty. Busch Systems is improving lives in ethical collection communities in collaboration with Plastic Bank and, in 2024, Busch Systems will help stop the equivalent of 3.1 million plastic bottles from entering the ocean in collaboration with Plastic Bank.

In partnership with Plastic Bank, Busch Systems is directly contributing to five of the 17 United Nations Sustainable Development Goals.
(SDGs 1, 8, 12, 14, 17)



To learn more about Plasticbank, visit: buschsystems.com/sustainability



SPECTRUM® series | Being green just got more colorful

- **INTERCHANGEABLE AND ADAPTABLE** - Modular system allows your centralized station to grow with your program.
- **SUPERIOR FINISH** - Powder coated steel body available in bright colors to help with stream recognition or to match your modern décor.
- **LARGE CAPACITY IN SMALL SPACES** - Small footprint makes it ideal for a wide range of locations.
- **ENCOURAGES DIVERSION** - Lead in embossed lids available in several restrictive openings.
- **ERGONOMIC SERVICING** - Plastic LDPE liners offer handles, are easy to clean and prevent leaks.
- **STABLE AND SAFE FOR ALL ENVIRONMENTS** - Rubberized, non skid feet help secure the containers without damaging floors or permanent mounting.

STOCK FINISHES

- Black
- Blue
- Grey
- Green
- White

ADDITIONAL AVAILABLE LID OPTIONS



*Only available for Cube Slim Body.

SPECIFICATIONS

- ELLIPSE-SLIM | 30.25 LITER**
400mmD x 205mmW x 775mmH
- CUBE-SLIM | 37.85 LITER**
400mmD x 205mmW x 775mmH
- ELLIPSE | 83.25 LITER**
400mmD x 400mmW x 775mmH
- CUBE | 90.85 LITER**
400mmD x 400mmW x 775mmH
- XL CUBE | 121 LITER**
400mmD x 545mmW x 775mmH



ELLIPSE-SLIM
30.25L



CUBE-SLIM
37.85L



ELLIPSE
83.25L



CUBE
90.85L



XL CUBE
121L
*Available with
Ashtray, Full or
Mixed Opening

*Minimum order quantities may apply.

BIM
OBJECT

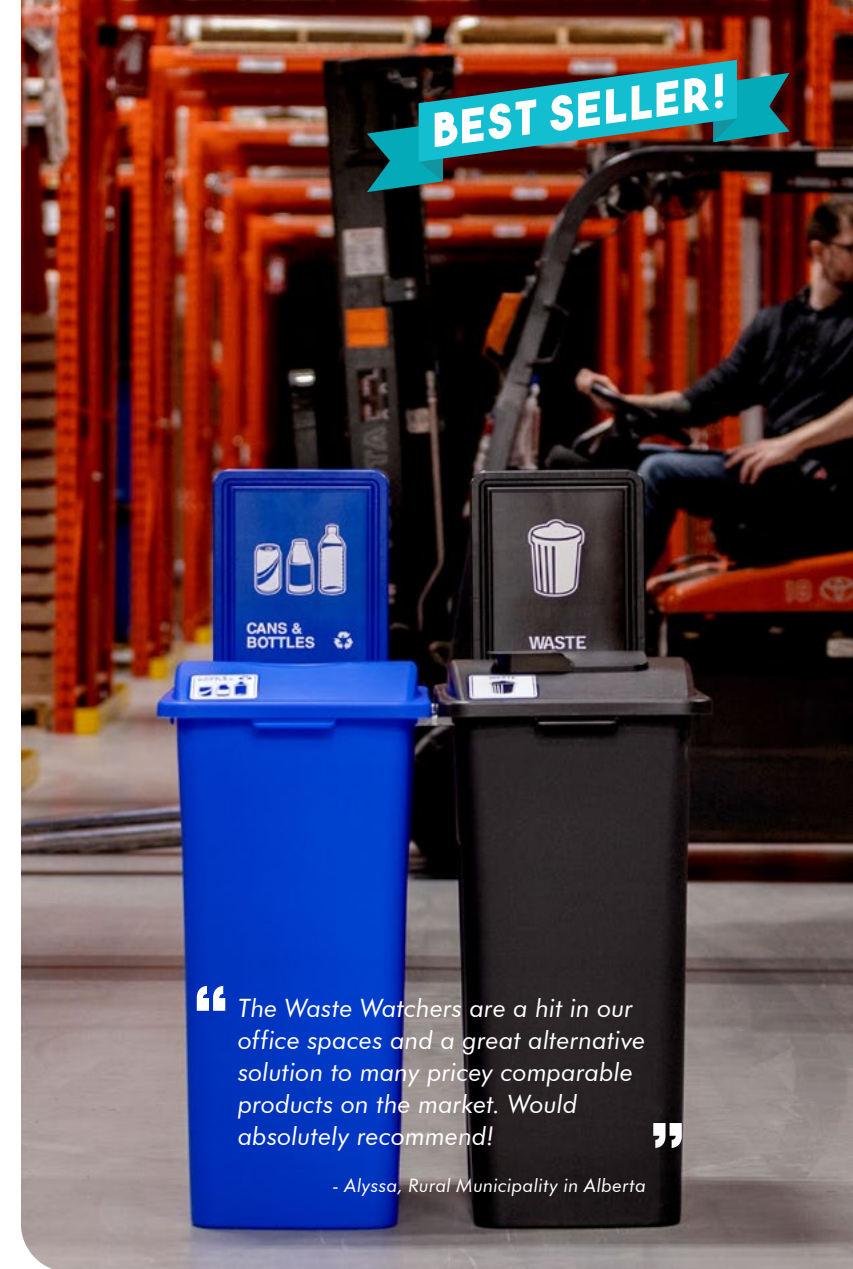

WASTE WATCHER® | For Maximum Diversion



- **EASY SNAP-TOGETHER ASSEMBLY** – Your station will be hassle-free and quick to assemble without the need for any tools. Save time and effort with this user-friendly design!
- **CLEAR COMMUNICATION** – Choose from our various stocked sign options or customize your own to meet your brand standards. Also included is a clear plastic cover to protect your sign.
- **VERSATILITY** – Select from our stocked color options and capacities to meet the needs of your waste collection program and space restrictions.
- **THOUGHTFUL DESIGN** - Strategically placed handles help make servicing and relocation smooth and simple while inside rounded edges eliminate the buildup of dirt and grime in hard corners.

STOCK BODY & LID FINISHES

- Black
- Grey
- Blue
- Green
- Black PCR*
- Blue PCR*
- Grey PCR*

*Post-Consumer Recycled material not available for all components. Ask your sales representative or visit our website for further details.

LID OPTIONS



SPECIFICATIONS

610MM 60.5 LITER 535mmD x 280mmW x 610mmH	XL 610MM 91 LITER 535mmD x 395mmW x 610mmH
690MM 75.5 LITER 535mmD x 280mmW x 690mm H	XL 690MM 106 LITER 535mmD x 395mmW x 690mmH
760MM 87 LITER 535mmD x 280mmW x 760mmH	XL 760MM 121 LITER 535mmD x 395mmW x 760mmH

Measurements listed are bodies with no lids

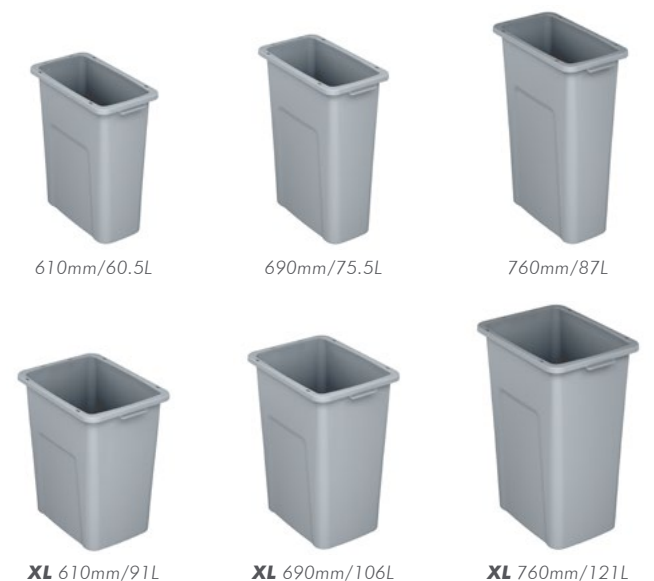



RENEGADE™ SERIES

Big, beautiful
and sustainable



This durable, high-capacity container is perfect for any outdoor environment. Made from 100% Post-Consumer Recycled Content with blow-molded construction, the Renegade is on the leading edge of circular-economy sustainability and quick & efficient manufacturing, allowing us to get this future-conscious product to you exactly when you need it.

- **HIGH-CAPACITY** - With a capacity of 189.25 liters you'll save time and money servicing this easy-to-maintain container.
- **ENVIRONMENTALLY CONSCIOUS** - Made from 100% PCR, the Renegade is produced with a smaller carbon footprint and is fully recyclable at the end of life.
- **PROTECTIVE RAIN HOOD** - The uniquely designed canopy lid keeps precipitation out of the container, leaving contents dry and protected.

STOCK FINISHES

■ Black ■ Blue

SPECIFICATIONS

**SINGLE
189.25 LITER**

505mmD x 505mmW x
1060mmH



FULL



MIXED

CIRCLE

OUTLAW™ SERIES

Breaking the Mold



*Body only

This durable, high-capacity container is perfect for any indoor environment. The Outlaw's body is made from 100% Post-Consumer Recycled Content with blow-molded construction and is on the leading edge of circular-economy sustainability with quick & efficient manufacturing, allowing us to get this future-conscious product to you exactly when you need it.

- **HIGH-CAPACITY** - With a capacity of 189.25 liters, you'll save time and money servicing this easy-to-maintain container.
- **ENVIRONMENTALLY CONSCIOUS** - With its body being made from 100% PCR, it is produced with a smaller carbon footprint, in addition to being fully recyclable at the end of life.
- **HIGH-END AESTHETIC** - The Outlaw's lid adds a high-end look to your space with a brushed pewter finish and choice of mixed or full restrictive openings.

STOCK FINISHES

■ Black ■ Blue

SPECIFICATIONS

**SINGLE
189.25 LITER**

505mmD x 505mmW x
760mmH



FULL



MIXED



Boka™ | Premium design and functionality

- **SUPERIOR DURABILITY** - This stainless steel container is a long lasting, durable solution for any indoor setting.
- **SUCCESSFUL DIVERSION** - 360 degree stream recognition helps increase diversion rate from all angles.
- **SAFETY OPTIONS AVAILABLE** - Unique lid design allows container to self extinguish fire by minimizing oxygen flow.
- **SIMPLIFIED SERVICING** - lockable, gas assisted hinged lids and a bag retention ring that keeps the bag secured upright.

STOCK FINISHES & SPECS

■ Stainless Steel

DOUBLE | 197 LITER
460mmD x 890mmW x 775mmH

TRIPLE | 295.25 LITER
460mmD x 1170mmW x 775mmH

**Single and XL Single Available
Minimum Order Quantity Applies*



DOUBLE 197L

TRIPLE 295.25L

BIM
OBJECT



ēVolve® | Modular system inspiring endless combinations
SERIES

- **EVOLVE WITH YOUR PROGRAM** - With countless configuration options in varying shapes and sizes, you can easily evolve your program by rearranging or adding to your existing stations.
- **PERFECT FOR HIGH-TRAFFIC AREAS** - Save money and time with a container that will hold more contents, reducing the need to service containers.
- **ENDLESS OPTIONS** - Choose from a variety of body styles, colors, lid options with restrictive openings, graphics, and accessories to improve the effectiveness of your program.

AVAILABLE FINISHES & SPECS

■ Black ■ Blue
■ Grey* ■ Green

**Minimum Order Quantity Applies*

CUBE | 189.25 LITER
510mmD x 510mmW x 765mmH

CUBE-SLIM | 87 LITER
255mmD x 510mmW x 765mmH

ELLIPSE | 136.25 LITER
510mmD x 510mmW x 765mmH



CUBE 189.25L

ELLIPSE 136.25L

CUBE-SLIM 87L

**Ellipse Containers Available
Minimum Order Quantity Applies*

BIM
OBJECT



CUSTOMIZE YOUR LABELS

Available for international shipping, minimum order quantity may apply. Reach out to our sales team for more information

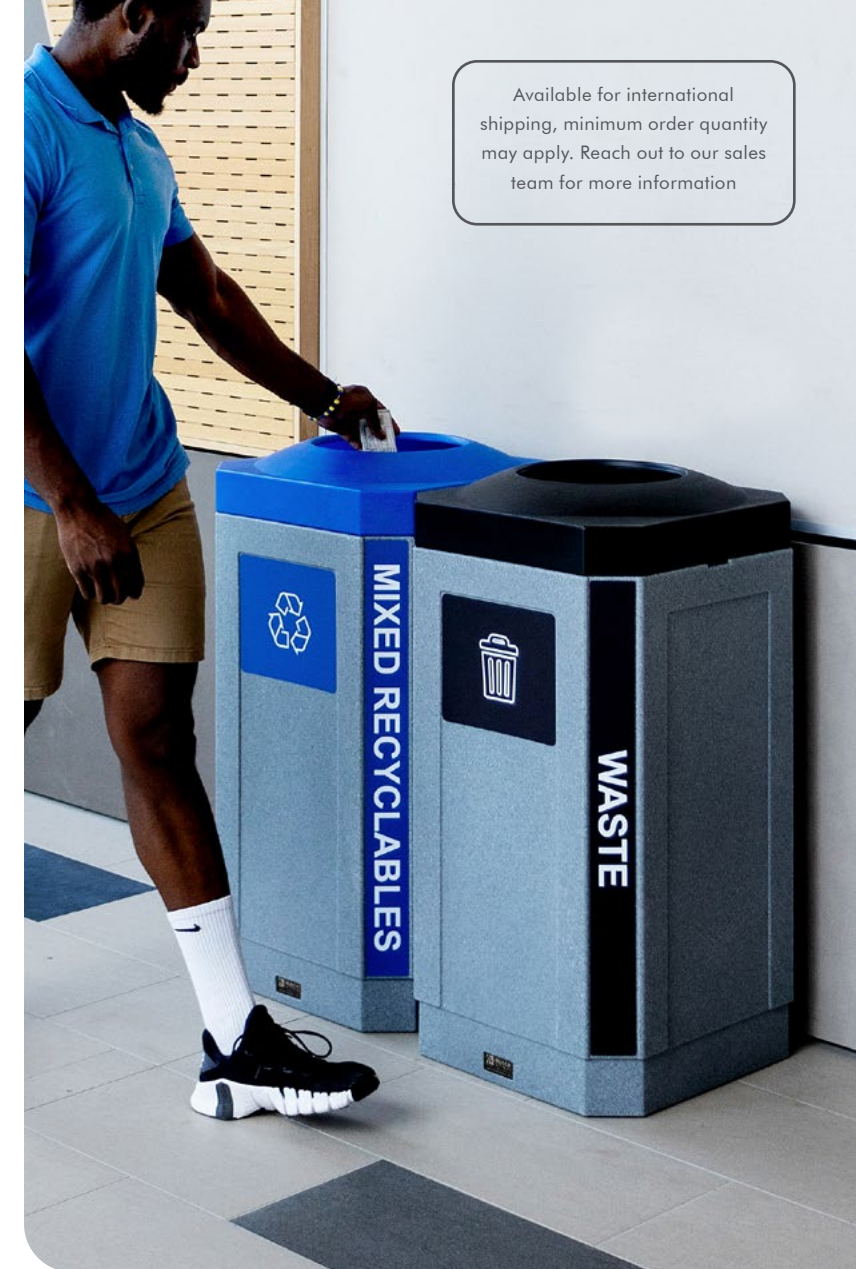

Available for international shipping, minimum order quantity may apply. Reach out to our sales team for more information

ASCEND™

Style Meets Sustainability

You CAN have it all! These centralized waste and recycling stations deliver a sleek, high-end aesthetic to complement any setting without sacrificing durability and serviceability. Available in a single, double, or triple stream, this container will deliver optimal diversion rates while maintaining upscale style.

- BUILT FOR ANY PROGRAM - Available in single, double or triple streams to meet your diversion needs.
- LIGHTWEIGHT DURABILITY - The roto-molded body is dent-resistant and perfect for high-traffic areas.
- ERGONOMIC SERVICING - With an easy-to-remove lid, full access to the container allows for quick and effortless servicing.

STOCK FINISHES

■ Black

SPECIFICATIONS

SINGLE 132.5 LITER

490mmD x 565mmW x 715mmH

DOUBLE 151.5 LITER

420mmD x 815mmW x 785mmH

TRIPLE 151.5 LITER

420mmD x 815mmW x 785mmH



SINGLE

DOUBLE

TRIPLE

∞
OCTO™
SERIES

Infinite possibilities

- A Single stream modular container is strong and long-lasting, ideal for both indoor and outdoor public spaces.
- The easy to maintain liner can be removed for servicing and cleaning, with a sloped lid design that helps keep precipitation out and discourages users from leaving items on top.
- Eight-sided design allows for ample labeling options with optional colored face plates to communicate stream differentiation and make it your own.

STOCK FINISHES

■ Greystone

■ Blue*

*Lid/Faceplate Only

■ Black*

■ Green*

SPECIFICATIONS

INDOOR | 121 LITER

495mmD x 495mmW x 935mmH

OUTDOOR | 121 LITER

495mmD x 495mmW x 1235mmH



INDOOR

OUTDOOR



ASPYRE™

COLLECTION

EXCEPTIONALLY CRAFTED
WITH OUR CUSTOMERS IN MIND



aura™

SERIES

BIM
OBJECT
MADE FROM
RECYCLED PLASTICS

- DISCOURAGE PRECIPITATION AND LITTER - Sloped lid keeps the top of the bin free from precipitation and litter build up while leading it away from the opening to keep contents dry and clean.
- SIMPLIFIED SERVICING - Front door access and rigid liners allow for easy servicing.

STOCK FINISHES

	Cedar		Grey
	Blue*		White*
	Black		Brown
	Green*		

*Not Available for posts.

XL VERSIONS AVAILABLE - See our website for sizing details

SPECIFICATIONS

SINGLE 121 LITERS
555mmD x 571.5mmW x 1117mmH
DOUBLE 242 LITERS
555mmD x 1054mmW x 1117mmH
TRIPLE 363.5 LITERS
555mmD x 1537mmW x 1117mmH

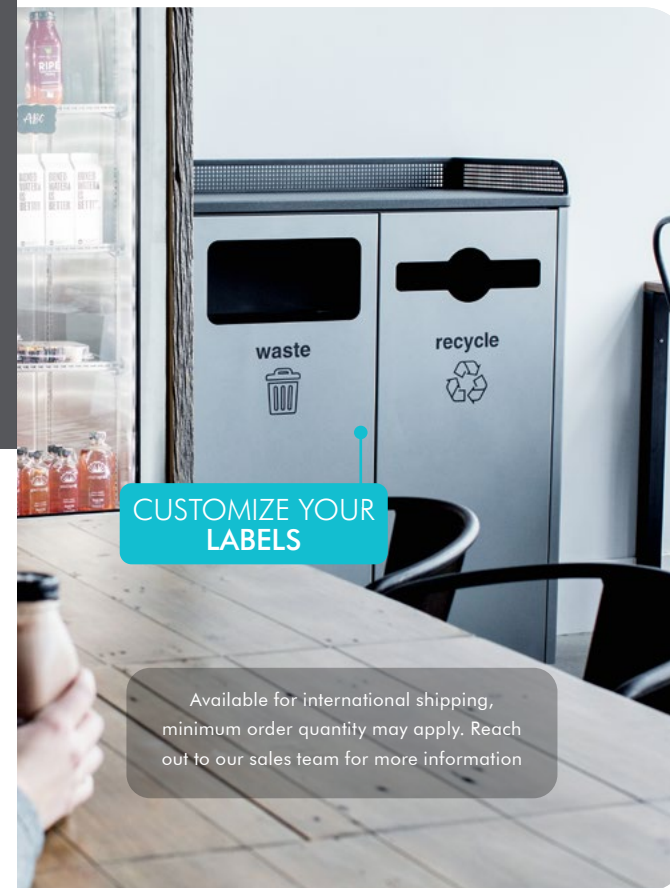

COURTSIDE™

Sustainability is a team effort, get in the game

- SERVICING HAS NEVER BEEN MORE SIMPLE - The Courtside's fenced in top intuitively communicates the users' responsibility to return their tray while magnetic front doors and rigid liners with handles make servicing of this large capacity container a breeze.
- DISCOVER YOUR LONG-TERM SOLUTION - Durable powder-coated steel construction will last years and mask wear & tear.
- PORTABLE AND EFFICIENT - Casters allow for easy transportation making it completely adaptable to changes in your space, as well as improving the ease of servicing the container.

STOCK FINISHES

- Sandtex Silver (Body)
- Black (Top Tray Holder)



SPECIFICATIONS

SINGLE 121 LITER
545mmD x 530mmW x 1215mmH
DOUBLE 242.25 LITER
545mmD x 955mmW x 1215mmH

VISION™

SERIES

MADE FROM
RECYCLED PLASTICS

- EASY DISPOSAL AND DIVERSION - Front facing openings with a variety of restrictive options to designate streams.
- VERSATILE FUNCTIONALITY - Flat top design allows for efficient collection of trays and other materials when applicable in an indoor setting.

STOCK FINISHES

	Cedar		Grey
	Blue*		White*
	Black		Brown
	Green*		

*Not Available for posts.

XL VERSIONS AVAILABLE - See our website for sizing details

SPECIFICATIONS

SINGLE 121 LITERS
520.5mmD x 520.5mmW x 1092mmH
DOUBLE 242 LITERS
520.5mmD x 1003mmW x 1092mmH
TRIPLE 363.5 LITERS
520.5mmD x 1486mmW x 1092mmH



INFINITE™

SERIES

Simplicity meets optimal functionality

- The curvy, textured LDPE body has a long lasting, weatherproof finish that masks wear and tear on the container.
- Optional caster kit available that enables the container to be relocated to a maintenance area for optimal servicing capabilities.
- To customize your program, the Infinite™ Series has multiple color options for the body and interchangeable bands, as well as restrictive opening options and endless labeling capabilities.

AVAILABLE FINISHES

- Black

SPECIFICATIONS

SELECT 132.5 LITER
495mmD x 605mmW x 805mmH
ELITE 142 LITER
510mmD x 620mmW x 910mmH



Select Patent: US D842,571 S
Elite Patent: US D804,762 S

OFFICE COMBO SERIES

Classic, best-selling designs

- Peer-reviewed, proven-to-work bins. *
- Neatly fits under any desk to encourage more recycling.
- Both the Deskside Recycler and Recycling & Waste Baskets are proven to improve recycling rates when paired with the Hanging Waste Basket.
- Select colors and styles made of 100% Post-Consumer Recycled Material.



SPECIFICATIONS

HANGING WASTE BASKET

2.85 LITER
145mmD x 200mmW x 165mmH

STOCK FINISHES

- Grey
- Busch Blue
- Green
- Black PCR

SPECIFICATIONS

RECYCLING & WASTE BASKETS

14 QUART | 13.25 LITER
295mmD x 205mmW x 310mmH
28 QUART | 26.5 LITER
370mmD x 265mmW x 385mmH
41 QUART | 37.85 LITER
390mmD x 285mmW x 510mmH

STOCK FINISHES

- Grey
- Royal Blue
- Green
- Black PCR
- Royal Blue PCR
- Green PCR
- Grey PCR

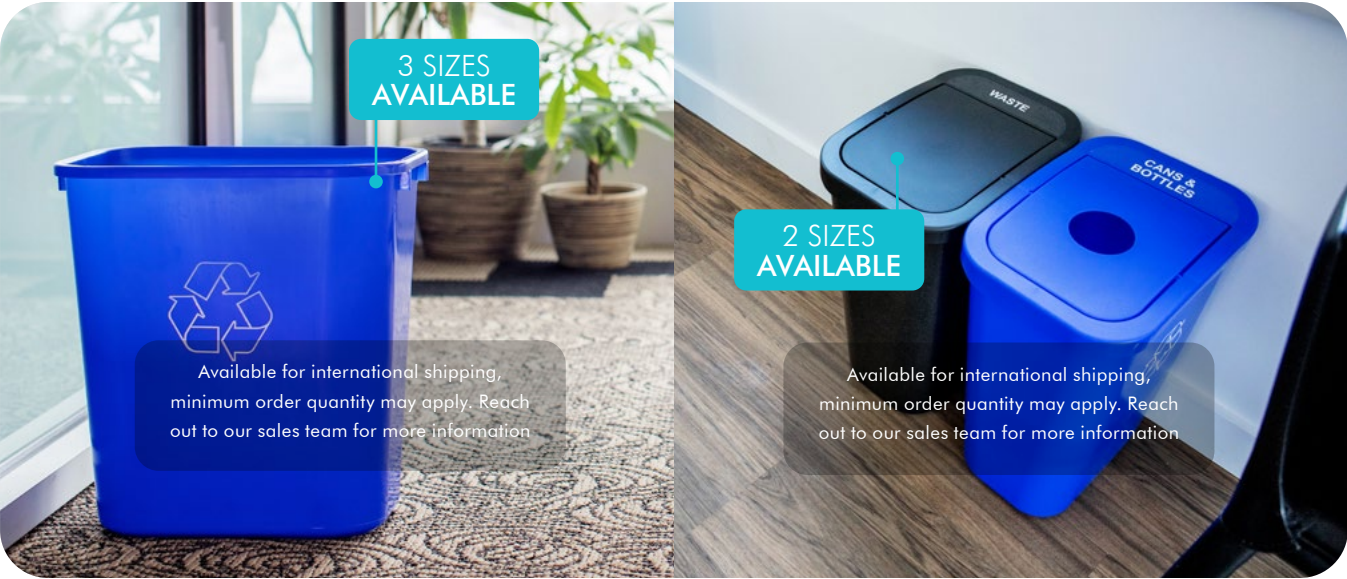
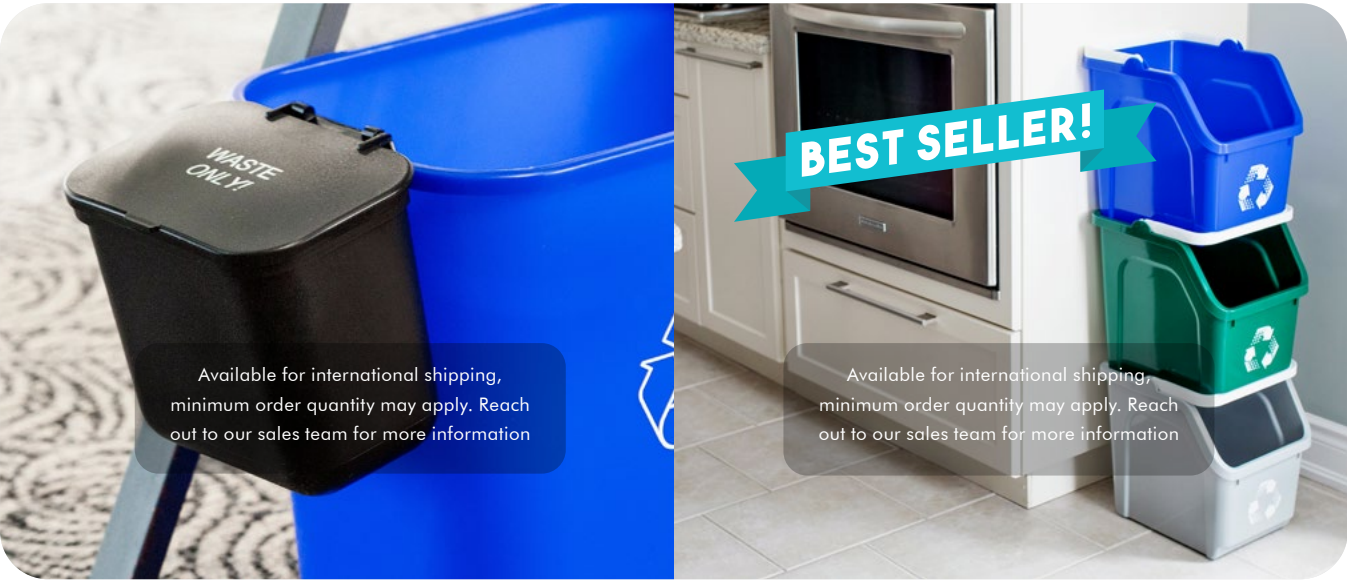

MULTI RECYCLER™

Stacking up sustainability

- THE ULTIMATE SPACE SAVER - This multi-purpose container saves space with its patented stackable design.
- EASY DISPOSAL - Ergonomic handle & slanted opening
- SATISFYING ORGANIZATION - Various colors allow you to have multiple streams to separate items easily.
- OPTIMAL ACCESSIBILITY - Access the contents of your containers easily even when stacked with the strategically designed opening.

STOCK FINISHES

- Blue
- Green
- Grey
- Yellow
- Red

SPECIFICATIONS

22.75 LITER
360mmD x 275mmW x 340mmH
Patent: US 8,950,581 B2

Billi Box™

Centralized collection for smaller spaces

- COMPACT SPACE SAVER - Available in 26.5 & 37.85 liter containers that are both perfect for low-traffic, centralized locations.
- VERSATILE AND CUSTOMIZABLE - Stocked in an array of colors with varying lid options available allowing this product to be specifically tailored to brand & program needs.
- CLEAN AND EASY SERVICING - Inside rounded edges eliminate build up of dirt and grime in corners.

STOCK FINISHES

- Black
- Grey
- Blue
- Green

SPECIFICATIONS

SINGLE | 26.5 LITER
375mmD x 270mmW x 400mmH
SINGLE | 37.85 LITER
395mmD x 285mmW x 530mmH

BATTERY RECYCLER™

series

Perfect for Storage of Used Batteries

AVAILABLE FINISHES

- Natural-Orange
- Brown

SPECIFICATIONS

8.5 LITER
215mmD x 230mmW x 305mmH

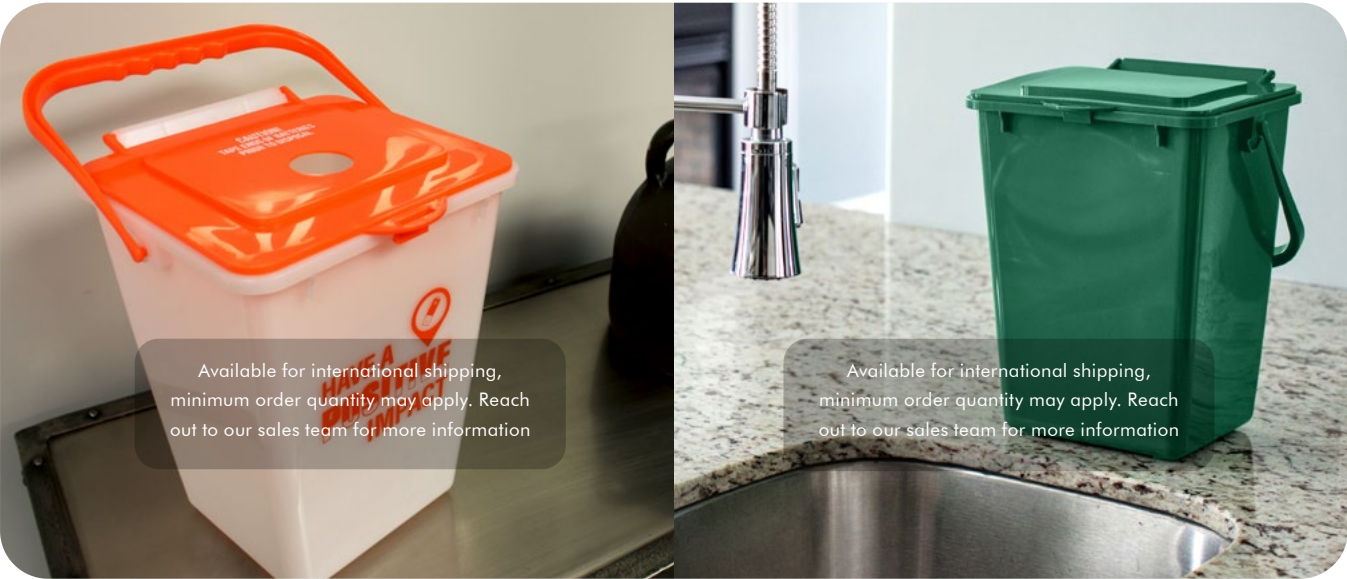

Kitchen Composters™

Composting within Reach

- EASY ACCESS - Snap-lock lid opens and closes effortlessly.
- SIMPLE CLEANING AND MAINTENANCE - Rounded corners to discourage buildup of food waste and dishwasher safe for easy cleaning.
- LIGHTWEIGHT AND OUT OF SIGHT - Small enough to fit under your sink but large enough to collect food waste without frequent servicing. Fits all standard paper and biodegradable composting bags.
- Now molded from 100% post-consumer recycled plastics.

STOCK FINISHES

- Compost Green PCR

SPECIFICATIONS

8.5 LITER
230mmD x 240mmW x 305mmH



