



LABELS ARE NOT EASILY ADJUSTED SO BE SURE TO APPLY THEM CORRECTLY USING THESE SIMPLE STEPS

STEP-BY-STEP INSTRUCTIONS:

- 1** Start by cleaning the surface so that it is free of any dust or dirt. Slowly peel the top portion of the backing away from the label (FIG 1)
- 2** Line up the top of the label where you want to apply it and slowly glide your hands back and fourth down the label (FIG 2)
- 3** Slowly peel off the rest of the backing, apply pressure and remove any air bubbles or imperfections as you glide along (FIG 3)



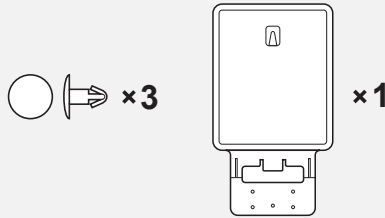

SIGNFRAME KIT CONTAINS:
1 SIGNFRAME WITH 3 SECURING CLIPS

STEP-BY-STEP INSTRUCTIONS:



- 1 Tip the signframe and insert the two hooks under rim, on short end of bin.
- 2 Push sign up into position.
- 3 Support tab will slide over handle edge and rest in the handle.
- 4 Mark holes (FIG 1) [or align holes if pre-drilled].
- 5 Remove signframe and drill holes with $1\frac{1}{64}$ drill bit (FIG 2) [if not already pre-drilled].
- 6 Repeat steps 1, 2, 3.
- 7 Align the signframe and container hole by pushing signframe upward (FIG 3).
- 8 Insert the securing clips with the heads inside the container.
- 9 Slide 8.5x11" sign through top slot of signframe.

