





**WASTE BINS MADE BETTER.**

VERSION 1.0

  
**GREAT  
PEOPLE**  
WORKING  
TOGETHER  
*to create*  
**POSITIVE  
CHANGE**  
IN THE WORLD 

## WHY BUSCH?



### **Certified B Corporation®**

We are proud to be a part of a global movement of people using business as a force for good™



### **Experience**

With 30+ years, we know our stuff and love to share it with you!



### **The Most Trusted**

#1 rated recycling & waste container brand according to Trustpilot.



We strive to maximize  
**Recycled Content**  
in our containers!



Proudly made in  
**North America**



### **Tailored By You**

Customization is our middle name!



### **Personalized Support**

Unique access to a team of full-service diversion experts.



### **Project Rise**

A donation is made with every purchase!



### **Giving Back**

We support local and national charities.

*In an effort to produce a more sustainable catalog with fewer pages, we have intentionally not included all of our products here. Contact our sales team at 1-800-565-9931 or check out our website to see our full product line!*

 PRINTED WITH ECO-CONSCIOUS INKS & PAPER



# WASTE BINS MADE BETTER.



**"For us, it's about more than just garbage collection. We've taken what's currently in the market and made it better."**

*Craig Busch* — Founder, President & Chief Design Officer

It's time for product innovation and environmental impact to meet the Waste Bin. Introducing: *Blue Wave*, powered by *Busch Systems®*. These carefully curated containers have been thoughtfully researched, designed and tested to be better than your traditional garbage bin. Each bin has been created through Craig's vision of waste bins reinvented. You choose what's important to you; We have a bin that will make that happen!

## WHAT MAKES THIS BIN BETTER?

### Our Lowest Carbon Footprint!



### More Environmental

Whether it's because their carbon footprint is less than the traditional waste bin, or it's made from recycled materials. Each of these containers meets the standard of being a more environmentally friendly option than is currently on the market and all are fully recyclable at the end of life.

**Learn More About CarbonGraph on PAGE 6**



### Superior Functionality

Through market research, and thoughtful design, each Blue Wave product is designed to function better than a traditional waste bin. Whether that's through ergonomic design for easy maintenance and collection; thoughtful design of rain hoods and front doors; longevity to its core, with the longest possible life-cycle and least amount of surface maintenance; Communication and customization abilities that are truly endless.



### Social Responsibility

Would anything be truly Busch Systems® if we didn't do our best to make the biggest impact possible?! With this initiative, we have partnered with Plastic Bank. You will be helping stop plastic from entering the world's oceans, while providing income and life-improving benefits to community members in vulnerable coastal areas that collect plastic. In 2023/2024, Busch Systems will help stop the equivalent of 2.2 million plastic bottles from entering the ocean in collaboration with Plastic Bank®.

**Learn More About Plastic Bank® on PAGE 22**





**Innovation is at the heart of what we do, and we are proud to have partnered with CarbonGraph.**

**Working together to make a difference!**

Innovation is at the heart of what we do, and we are proud to have partnered with CarbonGraph, an innovative technology, to determine the carbon footprint of our products. Founded in 2021, CarbonGraph's mission is to provide people, companies and governments the environmental context needed to make informed decisions about the sustainability of the goods and services they buy and sell.

In addition to mapping the carbon footprint of our products, the Busch Systems team has been working hand-in-hand with the CarbonGraph team to develop their software and be an example of the steps other companies can take in measuring their environmental impact through data and technology.



**Thank you for helping us reduce our carbon footprint**

We want to say thank you to Sam, Nicholas, Luke and the entire CarbonGraph team for their efforts that will have a lasting positive effect on our planet for years to come. We also want to extend a big thank you to our suppliers, who have worked with us and provided us with the information required to fully track the lifecycle of our products. And lastly, thank you to the continued efforts of our Operations and R&D teams who will be using this data and, along with their continued efforts to include increased amounts of Post-Consumer Recycled Content in all our containers, will now find more ways to reduce our carbon footprint. This will be an ongoing project for us, and we invite you to follow our journey! We can't wait to share more with you.

**Why does our carbon footprint matter?**

It's not a new realization that our planet is seeing the negative effects of carbon emissions through unusual climate changes and environmental events. Climate change is one of the most important environmental issues of our time. As humans, we cannot continue our current path, and must make a drastic and impactful change.

A carbon footprint is the total amount of greenhouse gases, including but not limited to carbon dioxide and methane, that are generated through our actions, activities and products. More specifically, a product's carbon footprint measures the total amount of greenhouse gas emissions through its lifecycle – from raw material extraction and production to its final use by consumers.



Throughout our journey of completing the carbon footprint of our products, we began to see the difference between the carbon footprint of the traditional metal waste container, and that of our innovative waste containers made from recycled plastic, recycled lumber and other plastic materials. The use of these non-metal materials has shown an overall reduction in the carbon footprint vs. a metal bin. The Busch Systems® Denver™ bin is an example of a traditional metal waste bin, and in order to quantify the difference in the carbon footprint between this commonly seen and commonly purchased waste bin, we have compared the carbon footprint of our Denver™ bin with that of our Blue Wave products. You will notice these comparisons throughout this catalog.



# EURO™ SERIES

The Euro™ is a modern European inspired container that will change the look of outdoor waste and recycling collection. This extremely durable container offers a built-in canopy and curved design, which not only protects from rain and precipitation, but emphasizes its high-end artistic appearance. With the option of one or two streams, lockability, and easy ground mounting, this container is the perfect fit for any outdoor setting.

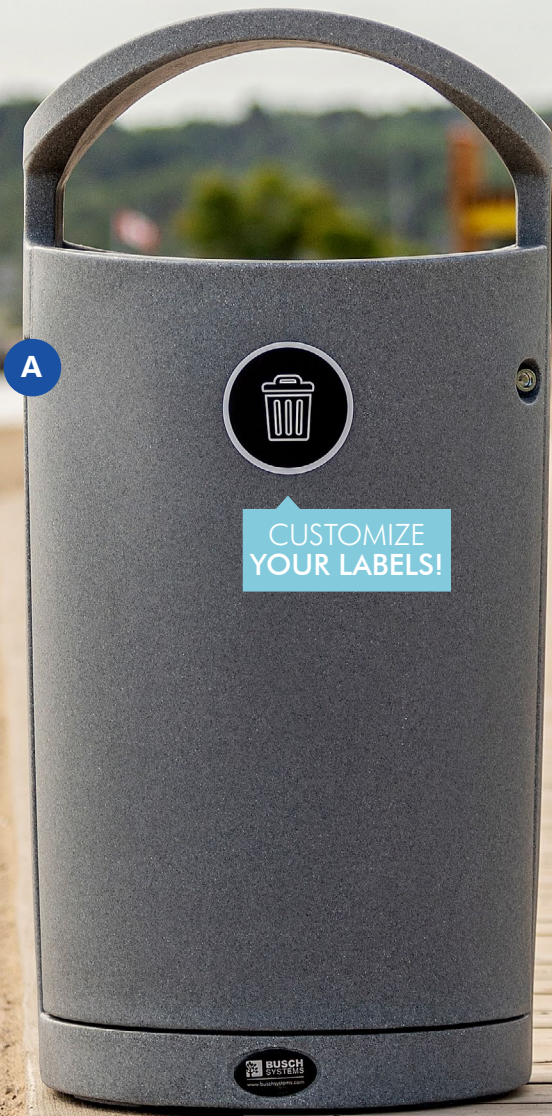

Carbon Footprint 96.8 kgCO<sub>2</sub>e  
Per 1 single unit

35% ↓ CO<sub>2</sub>e

Less than the traditional metal waste bin

Product carbon footprint created with

CarbonGraph



## WHAT MAKES THIS A BLUE WAVE BIN

- **HIGH-END AESTHETIC**  
Clean, simple, modern, and European inspired appearance
- **IMPRESSIVE DURABILITY**  
Double wall plastic makes an extremely sturdy outdoor bin
- **SIMPLIFIED SERVICING**  
Front door access and removable liner for easy ergonomic servicing
- **CLEAR COMMUNICATION**  
A small flat surface on the front of the container allows for easy label application or creates the perfect spot for a logo
- **SECURE AND STABLE**  
Can easily be weighted down to keep the bin in place, with a locking feature on each container

### STOCK FINISHES

- Greystone
- Sandstone



# EXPRESSION™ SERIES

The Expression™ is the only molded plastic container that effectively prioritizes signage! All four sides have space for customized signage, allowing you to differentiate streams or advertise your business. Made from double-wall plastic with a canopy lid that protects the contents from precipitation, this sturdy container is built to outlast any type of weather. Its simple yet sophisticated appearance is unique and fits perfectly into any outdoor space while adapting to the needs of your program.

Carbon Footprint

132.8 kgCO<sub>2</sub>e  
Per 1 single unit

10%

↓

CO<sub>2</sub>e

Less than the traditional metal waste bin

Product carbon footprint created with

 CarbonGraph





## WHAT MAKES THIS A BLUE WAVE BIN

- **AMPLE SIGNAGE**  
Signage space on all 4 sides of the container helps communicate streams and increase diversion rates
  - **CHANGEABLE SIGNAGE**  
Easily change your signage to suit your needs
  - **INCREASED CAPACITY**  
Available in single or double stream capacity to meet the needs of your program
  - **DURABILITY**  
Durable double-wall plastic does not rust and can outlast harsh weather condition
  - **INCREASED SECURITY**  
Optional bolting and locking feature available. Can also be easily weighted down
- **DISCOURAGES PRECIPITATION**  
Canopy lid keeps precipitation out of the container
  - **SIMPLIFIED SERVICING**  
Ergonomic front door access and removable liner

### STOCK FINISHES

-  Greystone
-  Sandstone

**105298 - SINGLE / OUTDOOR / SANDSTONE**  
23.5"W x 23.5"D x 48"H

**161035 - SINGLE / INDOOR / SANDSTONE**  
23.5"W x 23.5"D x 39.0625"H



# RENEGADE™ SERIES

This durable, high-capacity container is perfect for any outdoor environment. Made from 100% Post-Consumer Recycled Content with blow-molded construction, the Renegade™ is on the leading edge of circular-economy sustainability and quick & efficient manufacturing, allowing us to get this future-conscious product to you exactly when you need it.



## WHAT MAKES THIS A BLUE WAVE BIN

- **ENVIRONMENTALLY CONSCIOUS**  
Made from 100% PCR, the Renegade™ is produced with a smaller carbon footprint and is fully recyclable at the end of life
- **HIGH-CAPACITY**  
With a capacity of 50 gallons, you'll save time and money servicing this easy-to-maintain container
- **PROTECTIVE RAIN HOOD**  
The uniquely designed canopy lid keeps precipitation out of the container, leaving contents dry and protected
- **California Proposition 65 (Prop 65), REACH (Registration, Evaluation, and Authorization of Chemical Substances - EC1907/2006)**  
This product series is compliant with both Prop 65 and REACH regulations.

### STOCK FINISHES

- Black
- Blue



### Our Lowest Carbon Footprint!





# AURA™ SERIES

This long-lasting container is made of durable and weather resistant recycled lumber, combining sustainability, functionality, and convenience into one eye-catching design. The Aura's™ upscale appearance and high-quality construction create the perfect recycling and waste container for people who care.

Carbon Footprint 51.2 kgCO<sub>2</sub>e / 1 single unit

65%  
↓ CO<sub>2</sub>e  
Less than the traditional metal waste bin

Carbon Footprint 51.2 kgCO<sub>2</sub>e unit

Product carbon footprint created with CarbonGraph



As part of the  
**ASPYRE™**  
COLLECTION

## WHAT MAKES THIS A BLUE WAVE BIN

- CUSTOM COLORS & CONFIGURATIONS**  
Whether you're collecting pizza boxes or towels or are looking for a standardized collection system that matches your branding, the Aspyre™ Collection offers limitless customizable options that will complement your space! Our wide range of colors, configurations and lid opening options will be sure to boost your waste & recycling collection program.
- IMPRESSIVE RECYCLED LUMBER**  
Aura™ recycled lumber units are made from approximately 700 recycled milk jugs and were created to be impenetrable from moisture, pests, UV Rays, and harsh weather conditions
- SUPERIOR DURABILITY**  
Stainless steel hinges and heavy-duty screws complete the construction of a container that is built to last

- CLEAR COMMUNICATION**  
Optional front door signage allows a large visible space that can be seen from afar to designate streams and simplify waste diversion
- DISCOURAGE PRECIPITATION AND LITTER**  
Sloped lid keeps the top of the bin free from precipitation and litter build up while leading it away from the opening to keep contents dry and clean
- SIMPLIFIED SERVICING**  
Front door access and rigid liners allow for easy servicing

### STOCK FINISHES

- Cedar
- Black
- Grey
- Brown
- Blue\*
- Green\*
- White\*\*

\*Available for doors and openings.  
\*\*Not available for posts.



**104684 - SINGLE / BROWN**  
22.5"W x 21.85"D x 43.9"H

**105307 - SINGLE / LIFT LID / BLACK & GREY**  
22.5"W x 21.85"D x 43.9"H

**110318 - SINGLE / GREY & BLACK**  
22.5"W x 21.85"D x 43.9"H

**128075 - SINGLE / LOCK / GREY & WHITE**  
22.5"W x 21.85"D x 43.9"H

**171009 - SINGLE / BLACK**  
22.5"W x 21.85"D x 43.9"H



**198241 - SINGLE / GREY & WHITE**  
22.5"W x 21.85"D x 43.9"H





# VENTURE™ SERIES

Upgrade any waste and recycling program by incorporating a closed-loop product with a classic look. With endless customization options and a modern aesthetic, the Venture™ is a functional, durable, and reliable container - the ideal choice for any space!

Carbon Footprint 53.2 kgCO2e / 1 single unit

64%  
↓ CO2e

Less than the traditional metal waste bin

Carbon Footprint 53.2 kgCO2e / unit

Product carbon footprint created with

CarbonGraph

OPTIONAL  
JELLY EMBLEM  
LABELS!

As part of the  
**ASPYRE™**  
COLLECTION

## WHAT MAKES THIS A BLUE WAVE BIN

- CUSTOM COLORS & CONFIGURATIONS**  
Whether you're collecting pizza boxes or towels or are looking for a standardized collection system that matches your branding, the Aspyre™ Collection offers limitless customizable options that will complement your space! Our wide range of colors, configurations and lid opening options will be sure to boost your waste & recycling collection program.
- IMPRESSIVE RECYCLED LUMBER**  
Venture™ recycled lumber units are made from approximately 700 recycled milk jugs and are scratch resistant
- SUPERIOR DURABILITY**  
Stainless steel hinges and heavy-duty screws complete the construction of a container that is built to last

- EFFECTIVE COMMUNICATION**  
Optional backboard signage provides additional space to designate streams and divert waste while upscale 3D labeling highlights stream differentiation
- AVOID LITTER**  
Sloped lid with lead in openings discourages litter on top of the container
- SIMPLIFIED SERVICING**  
Front door access and slim rigid liners allow for easy servicing

### STOCK FINISHES

- Cedar
- Black
- Grey
- Brown
- Blue\*
- Green\*
- White\*\*

\*Available for doors and openings.

\*\*Not available for posts.



OPTIONAL  
SIGN FRAME  
AVAILABLE!

**104679 - SINGLE / CEDAR**  
15"W x 24"D x 41.5"H

**104680 - SINGLE / BLACK & GREY**  
15"W x 24"D x 41.5"H





# VISION™ SERIES

Standardize your recycling program with a modern container that is perfect for any indoor or outdoor setting. Durability and performance were key design factors in every detail in this container, effortlessly combining sustainability and practicality to create a Vision™ for the future of our environment.

Carbon Footprint 56.9 kgCO2e / 1 single unit

61%  
↓ CO2e  
Less than the traditional metal waste bin

Carbon Footprint 56.9 kgCO2e / unit

Product carbon footprint created with CarbonGraph

CUSTOMIZE  
YOUR SIGNS  
& LABELS!

As part of the  
**ASPYRE™**  
COLLECTION

## WHAT MAKES THIS A BLUE WAVE BIN

- CUSTOM COLORS & CONFIGURATIONS**  
Whether you're collecting pizza boxes or towels or are looking for a standardized collection system that matches your branding, the Aspyre™ Collection offers limitless customizable options that will complement your space! Our wide range of colors, configurations and lid opening options will be sure to boost your waste & recycling collection program.
- IMPRESSIVE RECYCLED LUMBER**  
Vision™ recycled lumber units are made from approximately 700 recycled milk jugs and are scratch resistant
- SUPERIOR DURABILITY**  
Stainless steel hinges and heavy-duty screws complete the construction of a container that is built to last

- EASY DISPOSAL AND DIVERSION**  
Front facing openings with a variety of restrictive options to designate streams
- EFFECTIVE COMMUNICATION**  
Optional front door and backboard signage provides additional space to designate streams and divert waste while upscale 3D labeling highlights stream differentiation
- SIMPLIFIED SERVICING**  
Front door access and rigid liners allow for easy servicing

### STOCK FINISHES

- Cedar

Black

Grey

Brown
- Blue\*

Green\*

White\*\*

\*Available for doors and openings.  
\*\*Not available for posts.



**104674 - SINGLE / BLACK**  
20.5"W x 20.5"D x 43"H

**104675 - SINGLE / BROWN**  
20.5"W x 20.5"D x 43"H

**105294 - SINGLE / XL / BLACK & GREY**  
27.5"W x 27.5"D x 48"H

**105295 - SINGLE / XL / CEDAR**  
27.5"W x 27.5"D x 48"H

**105308 - SINGLE / LIFT LID / BLACK & CEDAR**  
20.5"W x 20.5"D x 43"H

**119778 - SINGLE / XL / BLACK**  
27.5"W x 27.5"D x 48"H



RESTRICTIVE  
OPENINGS  
AVAILABLE!

**200153 - SINGLE / GREY**  
20.5"W x 20.5"D x 43"H





# CATALYST™ SERIES

The Catalyst™ Series is a revolutionary new indoor recycling and waste container incorporating a 100% post consumer recycled body along with a stylish stainless steel look durable ABS plastic lid. Designed for both functionality and aesthetics, the Catalyst™ is perfect for any office or public space looking to properly manage their waste and increase their sustainability. Featuring multiple lid opening options to encourage correct sorting of recyclables and waste, the Catalyst™ makes it easy for users to do their part in protecting the environment. The body of this container is made from sturdy, 100% post consumer recycled plastic that incorporates the ability to add in signage on all four sides. Take advantage of these areas for stream designation, advertising, promotions or wayfinding.

A

Carbon Footprint 35.3 kgCO2e  
Per 1 single unit

76% ↓ CO2e

Less than the traditional metal waste bin

Product carbon footprint created with

CarbonGraph

As part of the  
**ASPYRE™**  
COLLECTION



## WHAT MAKES THIS A BLUE WAVE BIN

- CUSTOM COLORS & CONFIGURATIONS**  
Whether you're collecting pizza boxes or towels or are looking for a standardized collection system that matches your branding, the Aspyre™ Collection offers limitless customizable options that will complement your space! Our wide range of colors, configurations and lid opening options will be sure to boost your waste & recycling collection program.
- LONG-LASTING SUCCESS**  
This container is practical in any indoor setting, built with extremely durable recycled lumber and reinforced with high-quality hardware to maintain its functionality and high-end appearance for years
- EASY MAINTENANCE**  
Removable lid and rigid, removable liner allows for easy servicing

- CUSTOMIZE YOUR MESSAGE**  
Easily add customized body signs for 360-degree communication for stream designation, advertising, promotions or wayfinding
- STOCK FINISHES**
- |       |        |        |       |
|-------|--------|--------|-------|
| Cedar | Black  | Grey   | Brown |
| Blue* | Green* | White* |       |
- \*Not available for posts or openings.







# WE HAVE JOINED THE SOCIAL RECYCLING MOVEMENT!

## What is Plastic Bank®?

Plastic Bank empowers the Social Recycling movement that stops ocean plastic and helps alleviate poverty in vulnerable coastal areas. Plastic Bank community members collect and exchange plastic waste as currency for secure income and life-improving benefits such as health, work and life insurance, digital connectivity, grocery vouchers, school supplies, and fintech services. The collected material is recycled and processed into Social Plastic® feedstock for reuse in products and packaging.

In July 2023, Busch Systems started its collaboration with Plastic Bank to help make an impact in stopping ocean-bound plastic. As part of our agreement, for the year 2023-2024 Busch Systems will help stop over 45,000 KG of plastic from entering the ocean in collaboration with Plastic Bank.

➔ [www.plasticbank.com](https://www.plasticbank.com)

WE'RE COMMITTED TO STOPPING

# 2,200,000

PLASTIC BOTTLES FROM ENTERING OUR OCEAN



## PROMOTIONAL

Custom Stamp  
your logo on any of our  
Promotional Products!



Mini Roll-Out Recycling Cart



Mini Curbside

For more information, please visit our website  
or contact your sales representative today!

# Thank You

By choosing Busch Systems you have already  
made the decision to be more sustainable.  
Thank you for being as passionate about  
the environment as we are. We appreciate  
your business and are thankful for over  
35 years of environmental collaboration!



