

IMPORTANT:

Boka Canopy must be hard ground mounted to prevent tipping hazard

INCLUDED IN YOUR MOUNTING KIT



1 x Mounting Bracket



4 x Lag Bolt



4 x Bolt



4 x Washer

EQUIPMENT YOU WILL NEED

- HAMMER DRILL
- 3/8" (OR 10MM) MASONRY DRILL BIT
- RATCHET
- 3/8" (OR 10MM) SOCKET
- 7/16" (OR 11MM) NUT DRILL BIT

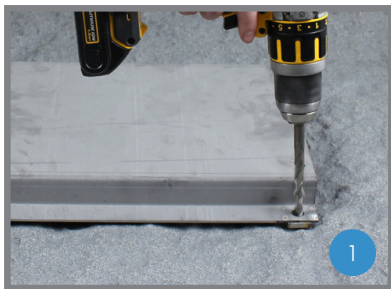

1
Position mounting bracket on ground. Drill pilot holes through the four outer larger holes.



2
Place lag bolts through the mounting bracket into each hole.



3
Tighten all four bolts with ratchet.

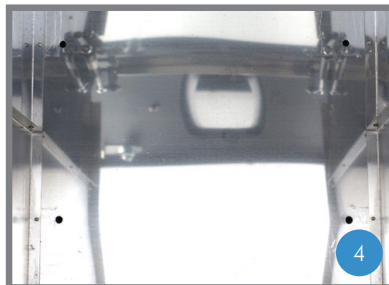

4
Place the unit on the mounting bracket and align the four holes in the bottom of the unit with the holes in the top of the mounting bracket.



5
Fasten bolts through the body to the mounting bracket.